



# Panasonic®

## Operating Instructions Basic Guide

### Wireless Presentation System For business use

# PressIT

Model No. **TY-WPS2**

WPS Basic Set

**TY-WPSC2**

WPS USB-C Basic Set

**TY-WPB2**

WPS Transmitter

**TY-WPBC2**

WPS USB-C Transmitter

**TY-WPR2**

WPS Receiver

\* WPS is an abbreviation of "Wireless Presentation System".

Thank you for purchasing the Panasonic product.

- Please read these instructions before operating this product and retain them for future reference.
- **Be sure to read "Safety Precautions" (page 6 to 8) before use.**
- These Operating Instructions are shared by TY-WPS2, TY-WPSC2, TY-WPB2, TY-WPBC2 and TY-WPR2.

English

Safety Precautions	6
Main unit and accessories	9
Part Names	10
Connection	12
Basic Use	14
Fixing the Transmitter Connection	17
Transmitter Extension Method (Pairing)	18
Installing the Receiver	19
Notes on the wireless function of this product	21
Request Regarding Security	23
Specifications	25

<b>Български</b>	<p><b>Прочетете преди употреба</b></p> <p>Информация за безопасност и важни бележки относно този продукт са описани в „Инструкции за работа - Кратък наръчник“. „Инструкции за работа - Кратък наръчник“ е налично на вашия език. Посетете следния уебсайт:</p> <p><a href="https://docs.connect.panasonic.com/prodisplays/">https://docs.connect.panasonic.com/prodisplays/</a></p>	<b>Deutsch</b>	<p><b>Vor Gebrauch lesen</b></p> <p>Sicherheitsinformationen und wichtige Benachrichtigungen bezüglich dieses Produktes werden in "Bedienungsanleitung - Basisanleitung" beschrieben. Die "Bedienungsanleitung - Basisanleitung" ist in Ihrer Sprache verfügbar. Bitte besuchen Sie die folgende Webseite.</p> <p><a href="https://docs.connect.panasonic.com/prodisplays/">https://docs.connect.panasonic.com/prodisplays/</a></p>
<b>Čeština</b>	<p><b>Čtěte před použitím</b></p> <p>Bezpečnostní informace a důležitá upozornění týkající se tohoto produktu jsou popsány v „Provozní pokyny – Základní příručka“. „Provozní pokyny – Základní příručka“ je k dispozici ve vašem jazyce. Navštivte prosím následující webovou stránku.</p> <p><a href="https://docs.connect.panasonic.com/prodisplays/">https://docs.connect.panasonic.com/prodisplays/</a></p>	<b>Eesti</b>	<p><b>Lugege enne kasutamist</b></p> <p>Selle toote ohutusteavet ja olulisi märkusi on kirjeldatud jaotises „Kasutusjuhend – Põhijuhend“. „Kasutusjuhend – Põhijuhend“ on saadaval teie keeles. Külastage järgmist veebilehte.</p> <p><a href="https://docs.connect.panasonic.com/prodisplays/">https://docs.connect.panasonic.com/prodisplays/</a></p>
<b>Dansk</b>	<p><b>Læs før brug</b></p> <p>Sikkerhedsinformation og vigtige bemærkninger vedrørende dette produkt er beskrevet i "Betjeningsvejledning - Grundlæggende vejledning". "Betjeningsvejledning - Grundlæggende vejledning" er tilgængelig på dit sprog. Besøg følgende website.</p> <p><a href="https://docs.connect.panasonic.com/prodisplays/">https://docs.connect.panasonic.com/prodisplays/</a></p>	<b>Ελληνικά</b>	<p><b>Διαβάστε πριν τη χρήση</b></p> <p>Πληροφορίες για θέματα ασφάλειας και σημαντικές γνωστοποιήσεις όσον αφορά το συγκεκριμένο προϊόν περιγράφονται στις «Οδηγίες χρήσης – Βασικές οδηγίες». Οι «Οδηγίες χρήσης – Βασικές οδηγίες» είναι διαθέσιμες στη γλώσσα σας. Επισκεφτείτε τον παρακάτω ιστότοπο.</p> <p><a href="https://docs.connect.panasonic.com/prodisplays/">https://docs.connect.panasonic.com/prodisplays/</a></p>

<b>Español</b>	<p><b>Leer antes de utilizar</b></p> <p>La información de seguridad y los avisos importantes relativos a este producto se describen en las "Manual de instrucciones – Guía Básica". Las "Manual de instrucciones – Guía Básica" están disponibles en su idioma. Visite el siguiente sitio web.</p> <p><a href="https://docs.connect.panasonic.com/prodisplays/">https://docs.connect.panasonic.com/prodisplays/</a></p>	<b>Italiano</b>	<p><b>Leggere prima dell'uso</b></p> <p>Le informazioni di sicurezza e gli avvisi importanti relativi a questo prodotto sono descritti in "Istruzioni per l'uso – Guida di base". Le "Istruzioni per l'uso – Guida di base" sono disponibili nella lingua dell'utente. Visitare il seguente sito web.</p> <p><a href="https://docs.connect.panasonic.com/prodisplays/">https://docs.connect.panasonic.com/prodisplays/</a></p>
<b>Français</b>	<p><b>À lire avant utilisation</b></p> <p>Les informations de sécurité et les avis importants concernant ce produit sont décrits dans le « Mode d'emploi – Guide de base ». Le « Mode d'emploi – Guide de base » est disponible dans votre langue. Veuillez visiter le site Web suivant.</p> <p><a href="https://docs.connect.panasonic.com/prodisplays/">https://docs.connect.panasonic.com/prodisplays/</a></p>	<b>Latviešu</b>	<p><b>Pirms lietošanas izlasiet</b></p> <p>Informācija par drošību un svarīgi brīdinājumi attiecībā uz šo izstrādājumu aprakstīti "Lietošanas instrukcijas – Pamata pamācība". "Lietošanas instrukcijas – Pamata pamācība" ir pieejama jūsu dzimtajā valodā. Dodieties uz norādīto tīmekļa vietni.</p> <p><a href="https://docs.connect.panasonic.com/prodisplays/">https://docs.connect.panasonic.com/prodisplays/</a></p>
<b>Hrvatski</b>	<p><b>Pročitajte prije uporabe</b></p> <p>Sigurnosne informacije i važne obavijesti u vezi s ovim proizvodom navedene su u dokumentu „Upute za uporabu – Osnovni vodič”. Dokument „Upute za uporabu – Osnovni vodič” dostupan je na vašem jeziku. Posjetite internetsku stranicu navedenu u nastavku.</p> <p><a href="https://docs.connect.panasonic.com/prodisplays/">https://docs.connect.panasonic.com/prodisplays/</a></p>	<b>Lietuvių</b>	<p><b>Prieš naudojimą perskaityti</b></p> <p>Saugos informacija ir svarbūs su šiuo gaminiu susiję pranešimai aprašyti „Naudojimo instrukcija – Pagrindinis vadovas“. „Naudojimo instrukcija – Pagrindinis vadovas“ galima ir jūsų kalba. Apsilankykite šioje svetainėje.</p> <p><a href="https://docs.connect.panasonic.com/prodisplays/">https://docs.connect.panasonic.com/prodisplays/</a></p>

<b>Magyar</b>	<p><b>Használat előtt olvassa el</b></p> <p>A termékkel kapcsolatos biztonsági információk és fontos tudnivalók az „Kezelési útmutató – Alapvető útmutató” című kiadványban található. A „Kezelési útmutató – Alapvető útmutató” című kiadvány elérhető az Ön nyelvén. Kérjük, látogasson el a következő weboldalra.</p> <p><a href="https://docs.connect.panasonic.com/prodisplays/">https://docs.connect.panasonic.com/prodisplays/</a></p>	<b>Polski</b>	<p><b>Przeczytać przed użyciem</b></p> <p>Informacje dotyczące bezpieczeństwa i ważne uwagi dotyczące tego produktu opisano w dokumencie „Instrukcja obsługi — Skrócony przewodnik”. Dokument „Instrukcja obsługi — Skrócony przewodnik” jest dostępny w lokalnym języku. Można go znaleźć w poniższej witrynie internetowej.</p> <p><a href="https://docs.connect.panasonic.com/prodisplays/">https://docs.connect.panasonic.com/prodisplays/</a></p>
<b>Nederlands</b>	<p><b>Lezen voor gebruik</b></p> <p>Veiligheidsinformatie en belangrijke richtlijnen met betrekking tot dit product worden in “Gebruikersinstructies – Basishandleiding” beschreven. De “Gebruikersinstructies – Basishandleiding” is in uw taal beschikbaar. Ga naar de volgende website.</p> <p><a href="https://docs.connect.panasonic.com/prodisplays/">https://docs.connect.panasonic.com/prodisplays/</a></p>	<b>Português</b>	<p><b>Ler antes da utilizar</b></p> <p>As informações de segurança e os avisos importantes relacionados com este produto estão descritos nas “Manual de Utilização - Guia básico”. As “Manual de Utilização - Guia básico” estão disponíveis no seu idioma. Visite o seguinte website.</p> <p><a href="https://docs.connect.panasonic.com/prodisplays/">https://docs.connect.panasonic.com/prodisplays/</a></p>
<b>Norsk</b>	<p><b>Les før bruk</b></p> <p>Sikkerhetsinformasjon og viktige merknader om dette produktet er beskrevet i “Bruksanvisninger – Grunnleggende veiledning”. “Bruksanvisninger – Grunnleggende veiledning” er tilgjengelig på språket ditt. Besøk følgende nettsted.</p> <p><a href="https://docs.connect.panasonic.com/prodisplays/">https://docs.connect.panasonic.com/prodisplays/</a></p>	<b>Română</b>	<p><b>A se citi înainte de utilizare</b></p> <p>Informațiile de siguranță și notificările importante cu privire la acest produs sunt descrise în „Manual de utilizare - Ghid de bază”. Documentul „Manual de utilizare - Ghid de bază” este disponibil în limba dvs. Accesați următorul site web.</p> <p><a href="https://docs.connect.panasonic.com/prodisplays/">https://docs.connect.panasonic.com/prodisplays/</a></p>

Slovenčina	<p><b>Pred použitím si prečítajte</b></p> <p>Bezpečnostné informácie a dôležité upozornenia týkajúce sa tohto výrobku sú opísané v „Návod na obsluhu – Základná príručka“. „Návod na obsluhu - Základná príručka“ sú dostupné v tvojom jazyku. Prosím navštívte nasledujúcu webovú stránku.</p> <p><a href="https://docs.connect.panasonic.com/prodisplays/">https://docs.connect.panasonic.com/prodisplays/</a></p>	Svenska	<p><b>Läs före användning</b></p> <p>Säkerhetsanvisningar och viktiga meddelanden om den här produkten beskrivs i "Bruks anvisning – Grundläggande vägledning". "Bruksanvisning – Grundläggande vägledning" finns på ditt språk. Gå till följande webbplats.</p> <p><a href="https://docs.connect.panasonic.com/prodisplays/">https://docs.connect.panasonic.com/prodisplays/</a></p>
Slovenščina	<p><b>Pred uporabo preberite</b></p> <p>Varnostne informacije in pomembni napotki glede uporabe tega izdelka so opisani v »Navodilih za uporabo - Osnovni vodnik«. »Navodila za uporabo – Osnovni vodnik« je na voljo v vašem jeziku. Obiščite naslednjo spletno stran.</p> <p><a href="https://docs.connect.panasonic.com/prodisplays/">https://docs.connect.panasonic.com/prodisplays/</a></p>		
Suomi	<p><b>Lue ennen käyttöä</b></p> <p>Tätä tuotetta koskevat turvallisuustiedot ja tärkeät huomautukset on kuvattu kohdassa "Käyttöohjeet – Perusopas". "Käyttöohjeet – Perusopas" on saatavilla omalla kielelläsi. Vieraile seuraavalla verkkosivustolla.</p> <p><a href="https://docs.connect.panasonic.com/prodisplays/">https://docs.connect.panasonic.com/prodisplays/</a></p>		

# Safety Precautions

## **WARNING:**

**Stop using the product immediately when an abnormality or malfunction occurs.**

**Remove the power plug in the case of an abnormality.**

- Smoke is emitted, or abnormal smell or sound occurs.
- Video or audio is not reproduced in some cases.
- Liquid such as water or a foreign object has entered inside the product.
- The product is deformed or damaged.

Using the product in such states may cause a fire or electric shock.

- Remove the power plug from the outlet and request repair to the dealer where you purchased the product.
- It is necessary to remove the power plug to completely turn off the power of this product.
- Do not repair the product by the customer since it is dangerous.
- Use an outlet located at a position where the hand can reach easily so that the power plug can be removed quickly.

**Do not insert foreign objects into the product.**

Do not insert or drop metals or flammable items into the inside the product from the vent hole, etc.

Smoke is emitted, or abnormal smell or sound occurs.

- Keep an eye on children in particular.

## **■ About AC adaptor**

**Do not use an AC adaptor or AC adaptor cable other than those supplied with this product.**

Using an AC adaptor or AC adaptor cable other than those supplied may cause an electric shock or fire due to short circuit or heat generation.

**Clean the power plug periodically to prevent dust from accumulating.**

Failure to do so may cause a fire or electric shock due to moisture.

- Remove the power plug and wipe it with dry cloth.

**Do not insert or remove the power plug with wet hand.**

Doing so may cause an electric shock.

**Do not use the outlet or wiring devices exceeding rated values or with currents other than 100 – 240 V AC.**

Using them exceeding rated values by connecting too many plugs in one outlet may cause a fire due to heat generation.

**Insert the power plug securely to the end.**

Insufficient insertion may cause a fire due to an electric shock or heat generation.

- Do not use the product with a damaged plug or loose outlet.

**Do not damage the AC adaptor and power plug.**

( by damaging, modifying, forcibly bending, twisting, pulling or bundling them, bringing them close to heat appliances, placing heavy items on them, etc. )

Doing so may cause a fire or electric shock due to short circuit or disconnection.

- Request the dealer for repair of the AC adaptor or power plug.

**Use the product 15 cm or more away from a location where a cardiac pacemaker is embedded.**

Radio waves may affect the operation of the pacemaker.

**Do not use the product in an airplane.**

The operational safety may be impaired.

**Do not use the product near an automatic door, fire alarm or other automatic control devices.**

Radio waves from this product may affect automatic control devices, which may cause an operational error, resulting in an accident.

**Do not use the product in hospital or a location with medical equipment.**

Radio waves from this product may affect medical equipment, which may cause an operational error, resulting in an accident.

**Do not use the product while touching it for a long time.**

Touching the hot parts of the product and AC adaptor for a long time may cause a low-temperature burn\*.

- \* Persons with poor bloodstream (due to vascular impairment, poor blood circulation, diabetes or strong compression) or poor skin sensitivity (elderly persons) tend to get a low-temperature burn.

**Do not touch the product and AC adaptor if it begins to thunder.**

Doing so may cause an electric shock.

**Do not wet the product.**

Doing so may cause a fire or electric shock.

**Do not place the product on unstable locations.**

Placing the product on a shaky table or an inclined location may cause an injury due to falling over or dropping.

**Do not remove or modify the back cover (cabinet).**

**Keep the screws supplied with the receiver out of reach of infants.**

The screws may be accidentally swallowed.

- In the event this occurs, consult a doctor immediately.

**For installation, please ask a qualified technician or a dealer.**

If installation is not carried out and secured correctly, it can cause falling accidents.

**Do not touch the bottom surface of the transmitter during use.**

The bottom surface of the transmitter may be hot during and after use for a while, resulting in a burn injury.

Also, do not place it on an object sensitive to heat. Doing so may cause deformation or discoloration.

# Safety Precautions

Continued

## **CAUTION:**

**Do not block the vent hole of this product.**

**Do not push the product into a narrow and poorly ventilated space.**

Doing so may cause heat to accumulate inside, resulting in a fire or malfunction.

**Do not place a heavy item on the product.**

Doing so may cause a fire or malfunction.

**Do not place the product at a high-temperature location, humid or dusty location, or location subject to oil smoke or steam (such as a cooking table and humidifier).**

Doing so may cause a fire or electric shock.

**When removing the connection cables, be sure to hold the connector and pull it.**

Pulling the cord may damage the cord, resulting in a fire due to an electric shock or short circuit.

**When transferring the product, remove the connection cables of equipment beforehand.**

Failure to do so may damage the cord or product, resulting in a fire or electric shock.

**When not using the product for a prolonged period, remove the power plug from the outlet.**

Dust may accumulate in the power plug, resulting in a fire or electric shock.

**Do not pull or hang the connection cables.**

Doing so may cause the product to fall over or drop, resulting in an injury.

- Keep an eye on children in particular.

## **■ Maintenance**

**For maintenance, remove the power plug from the outlet for safety.**

Failure to do so may cause an electric shock.



# Main unit and accessories

Check that you have the main unit and accessories shown.

## WPS Basic Set TY-WPS2

### • Main unit

WPS Receiver  
(TY-WPR2) ..... 1

WPS Transmitter  
(TY-WPB2) ..... 2

### • Accessories

AC adaptor  
(DPVF4970ZA/X1)... 1  
(including 3  
conversion plugs)

AC adaptor cable  
(DPVF4960ZA/X1)... 1

HDMI cable  
(DPVF4971ZA/X1)... 1

USB extension cable  
(DPVF3513ZA/X1)... 2

Receiver mounting  
bracket  
(see page 19) ..... 1

Transmitter case  
(DPVF5002ZA/X1)... 1

## WPS USB-C Basic Set TY-WPSC2

### • Main unit

WPS Receiver  
(TY-WPR2) ..... 1

WPS USB-C Transmitter  
(TY-WPBC2) ..... 2

### • Accessories

AC adaptor  
(DPVF4970ZA/X1) .. 1  
(including 3  
conversion plugs)

AC adaptor cable  
(DPVF4960ZA/X1)... 1

HDMI cable  
(DPVF4971ZA/X1)... 1

Conversion adaptor  
for pairing  
(DPVF3516ZA/X1)... 1

Receiver mounting  
bracket  
(see page 19) ..... 1

Transmitter case  
(DPVF5002ZA/X1)... 1

## WPS Transmitter TY-WPB2

### • Main unit

WPS Transmitter  
(TY-WPB2) ..... 1

### • Accessories

USB extension cable  
(DPVF3513ZA/X1)... 1

## WPS USB-C Transmitter TY-WPBC2

### • Main unit

WPS USB-C  
Transmitter  
(TY-WPBC2) ..... 1

### • Accessories

Conversion adaptor for pairing  
(DPVF3516ZA/X1)... 1

## WPS Receiver TY-WPR2

### • Main unit

WPS Receiver  
(TY-WPR2) ..... 1

### • Accessories

AC adaptor  
(DPVF4970ZA/X1)... 1  
(including 3  
conversion plugs)

AC adaptor cable  
(DPVF4960ZA/X1)... 1

HDMI cable  
(DPVF4971ZA/X1)... 1

Receiver mounting bracket  
(see page 19) ..... 1

### Attention

- Store small parts in an appropriate manner, and keep them away from young children.
- The part numbers of accessories are subject to change without notice.  
(The actual part number may differ from the ones shown above.)
- In case you lost accessories, please purchase them from your dealer. (Available from the customer service)
- Dispose the packaging materials appropriately after taking out the items.

# Part Names

## ■ Receiver (TY-WPR2)

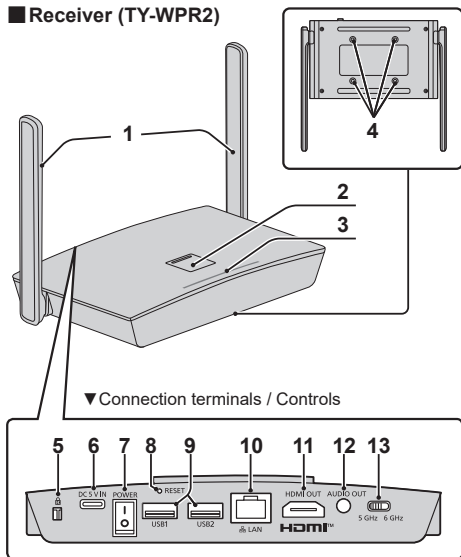

### 1 Antenna

### 2 FUNCTION button / LED

Used to display the status of this unit and for the remote pairing function.

### 3 Indicator

Displays the power supply status, and connection statuses of LAN and USB.

### 4 Screw holes for mounting bracket (page 19)

Used to attach the receiver to the mounting bracket.

## ▼ Connection terminals / Controls

### 5 Security Slot

This security slot is compatible with a Noble Wedge slot.

### 6 Power input terminal

### 7 Power switch

Turns ON (I) / OFF (O) the power of the receiver.

### 8 Reset button

Restores the product to the factory default state.

### 9 USB terminal (Type-A)

Connects the transmitter when pairing devices.

### 10 LAN terminal (RJ45)

Connects to the network to change the settings of the product.

### 11 HDMI output terminal

Connects an imaging device equipped with HDMI input.

### 12 Audio output terminal

Connects an external speaker, etc.

### 13 Radio band selection switch (page 15)

Switches depending on the band used (5 GHz or 6 GHz).

## ■ Transmitter (TY-WPB2)

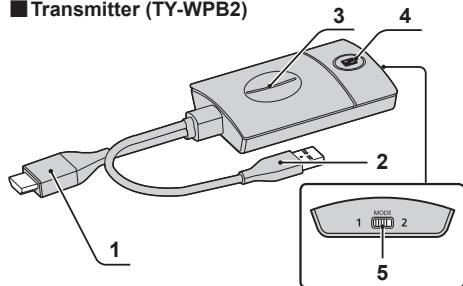

### 1 HDMI input terminal

Connect to an imaging device equipped with HDMI output.

### 2 USB terminal (Type-A)

Connect to a USB power supply device.

### 3 Main button / LED

Switches between on and off of image display.

### 4 Sub button / LED

Switches to the multi-screen mode.

### 5 Mode switch

Normally use "1".

This function may be available in future software upgrades. For details, read "Operating Instructions - Functional Manual".

### 6 USB terminal (Type-C)

Connect to an imaging device with USB Type-C output.

## ■ USB-C transmitter (TY-WPBC2)

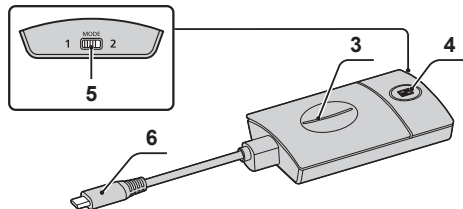

## ■ Transmitter case

2 (max. 4) transmitters and the USB extension cable can be stored.

<2 transmitters>

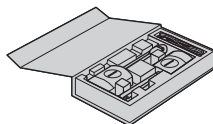

<4 transmitters>

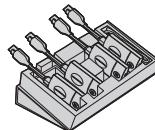

# Connection

Before connection, carefully read the operation manual of the device to be connected to this system.  
Turn off the power of each device before connecting cables.

## Connecting the receiver

- 1 Connect the AC adaptor and AC adaptor cable to the receiver for power supply.**
- ▶ Use an AC adaptor conversion plug that fits the shape of outlet.**

<How to remove>

- ① Press the button**
- ② Remove the plug**

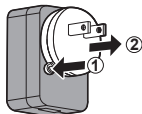

### Note

- Do not remove the AC adaptor conversion plug while it is connected to the outlet.

- 2 Connect a display device such as a display and projector to the receiver with HDMI cable.**

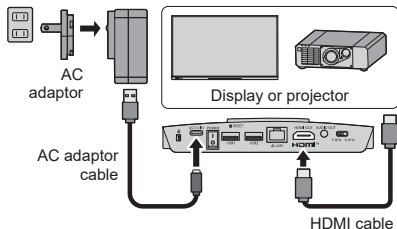

### Note

- For power supply to the receiver, use the supplied AC adaptor or a USB power supply device with 5 V/2 A.

- 3 Press the “I” side of the power switch on the receiver to turn on the power. When a standby screen is displayed on the display device, the receiver has completed preparation.**



Standby screen

### Connecting the transmitter

- 1 Connect the USB terminal and HDMI input terminal of the transmitter to the image output device.**
- For power supply to the transmitter, 5 V/0.9 A power supply is necessary.

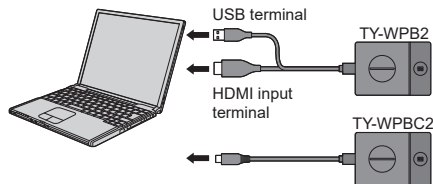

For the USB-C transmitter, connect the USB terminal (Type-C) to the image output device.

- 2 Main LED changes from red blinking (connecting) to white illumination (standby).**

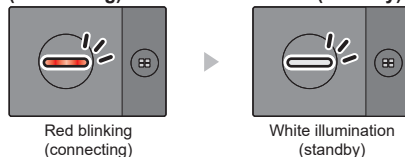

# Basic Use

## Single connection

This section describes how to display an image using one transmitter.

### 1 Press the main button of the transmitter while the standby screen is displayed.

The image is displayed.



Standby screen

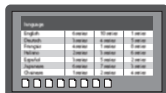

Full screen display

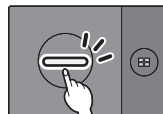

White illumination (standby)

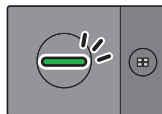

Green illumination (display)

### ▶ Pressing the main button again changes the main LED to white and returns to standby state. (The screen returns to the standby screen as well.)

- When using multiple transmitters, the image is switched to the image of the transmitter of which the main button is pressed.

## Multi connection

This section describes how to display images simultaneously using multiple transmitters. Images of up to 4 transmitters can be displayed simultaneously.

### 1 Press and hold the sub button of the transmitter for 1 second or more during full screen display.

The sub LED changes to green illumination, and the multi-screen mode is enabled.



Full screen display

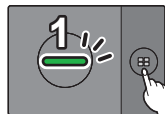

Sub LED  
OFF

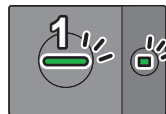

Sub LED  
Green illumination  
(Multi-screen mode)

## 2 Press the main button of the transmitter of which the image is to be added.

The image is added.

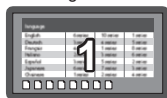

Full screen display

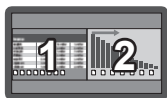

Multi-screen display

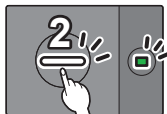

White illumination (standby)      Sub LED Green illumination

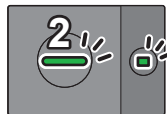

Green illumination      Sub LED Green illumination

### ▶ Multi-screen mode cancellation

**Press and hold the sub button of the transmitter for 1 second or more.**

- The sub LED changes from green illumination to OFF state, and the multi-screen mode is canceled.

## Characteristics of the radio band used by this product and switching between them

- This product has a function to switch the radio band connecting the transmitter and receiver.  
Mode using 5 GHz band : 5G mode  
Mode using 6 GHz band : 6G mode
- Switch using the radio band selection switch (page 10) on the receiver or from the web settings page.
- Even in 6G mode, radio waves of other frequencies may be output.
- Pairing with the transmitter is required when switching between 5G mode and 6G mode.

### Note

- If the transmitter is not paired when the mode is switched, the pairing state with the transmitter will be maintained in the original mode.
- In 6G mode, the usable range is narrower than in 5G mode, without distortion or interruption in video or audio.

- Especially when using 6G mode, transmission capabilities may be reduced if there is a shield between the transmitter and receiver. Especially when using 6G mode, install the receiver within the range where the receiver's antenna is visible.

Be especially careful in the following cases:

- When installing behind a display, etc.
- When installing next to a projector mounted on the ceiling
- When installing in a rack

### **Note**

- For details, read "Operating Instructions - Functional Manual".

### **Details of usage**

For details of usage, read "Operating Instructions - Functional Manual".

Download the "Operating Instructions - Functional Manual" from the following URL.

<https://panasonic.net/cns/prodisplays/wps2/>



# Fixing the Transmitter Connection

While multiple transmitters are paired and used, you can connect only one transmitter to the receiver and disable switching to another transmitter. This setting prevents accidental transmitter-switching operation.

## Setting the fixed mode

**Press and hold the main button of the transmitter for 1 second or more while an image of one transmitter is displayed.**

The main LED changes from green illumination to blue illumination, and the fixed mode is enabled.

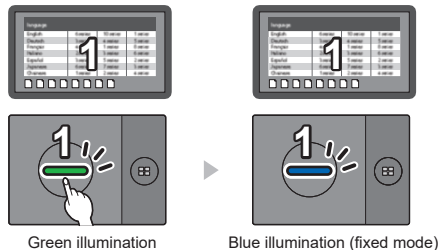

## Other transmitters

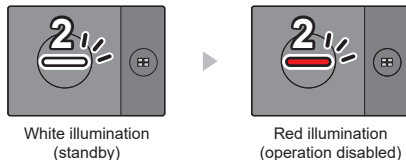

## Canceling the fixed mode

**Press and hold the main button of the transmitter for 1 second or more.**

The main LED changes from blue illumination to green illumination, and the fixed mode is canceled.

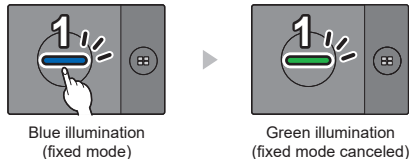

# Transmitter Extension Method (Pairing)

Pairing settings have been made for transmitter and receiver of TY-WPS2 Basic Set / TY-WPSC2 Basic Set.

## Pairing by connecting the receiver and transmitter

- 1 Slide the mode switch to the "1" side.



- 2 Connect the USB terminal of the transmitter to the USB terminal of the receiver.



TY-WPB2



To connect the TY-WPBC2, use the conversion adaptor for pairing supplied with the TY-WPSC2/TY-WPBC2.

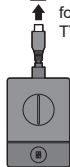

TY-WPBC2

Wait for a while until the LED of the receiver blinks in white. Then, pairing starts automatically.

"Pairing..." (pairing in progress) is displayed on the standby screen.

- 3 Pairing is complete.

"Pairing OK" is displayed and the LED of the receiver lights up in white.



- 4 Remove the USB cable of the transmitter from the receiver.

# Installing the Receiver

## Components for receiver mounting bracket

Check the following parts are included.

Base bracket (A) ..... 1  
(DPVF3503ZA/X1)

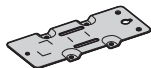

Sheet (B) ..... 2  
(DPVF3508ZA/X1)  
(24 × 20 mm)



Screw (C) ..... 4  
(DPVF3510ZA/X1)  
(M4 × 5)



## Installing on the ceiling or wall

- 1 Place the base bracket (A) aligning it with the 4 screw holes on the bottom surface of the receiver.
- 2 Fix the base bracket (A) with 4 screws (C).

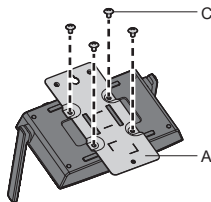

The base bracket can be mounted as shown below.

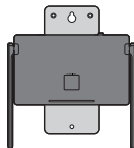

### **3** Fix the receiver to the ceiling or wall with 2 screws.

Use screws (commercially available) of the appropriate type and length according to the ceiling or wall to be installed. (Recommended size: M4)

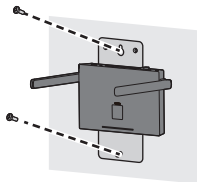

### Installing on the projector

The receiver can be installed on the projector.

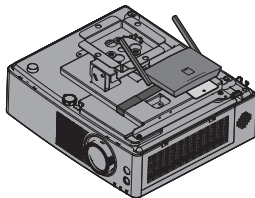

For details of installation method, read "Operating Instructions - Functional Manual".

Download the "Operating Instructions - Functional Manual" from the following URL.

<https://panasonic.net/cns/prodisplays/wps2/>

# Notes on the wireless function of this product

The wireless function of this product uses radio waves in the 2.4 GHz/5 GHz (W52)/6 GHz bands.

Be sure to read and fully understand the following items before use.

## **Use this product indoors.**

- This product is a wireless device that uses the 5 GHz (W52) and 6 GHz bands. Using this product outdoors is prohibited by the Radio Act.

## **If at all possible, avoid the use of cellular phones, TV sets or radios near the product.**

- Cellular phones, TV sets, radios and similar devices use different radio bands from the product, so there is no effect on wireless communication or the transmission and reception of these devices. However, radio waves from the product may produce audio or video noise.

## **Wireless communication radio waves cannot penetrate steel reinforcements, metal, concrete, etc.**

- Communication is possible through walls and floors made from materials such as wood and glass (except glass containing wire mesh), but not through walls and floors made from steel reinforcements, metal, concrete, etc.

## **The product may not work properly due to strong radio wave from the broadcast station or the radio.**

- If there is any facility or equipment, which outputs strong radio wave, near the installation location, set up the product at a location sufficiently far from the source of the radio wave.

## **Using the product outside the country**

- It is forbidden to take the product outside the country or region where you purchased it, so use it only in the said country or region. Also, note that depending on countries or regions there are restrictions on the channels and frequencies at which you can use the wireless LAN.

### Declaration of Conformity (DoC) for EU:

"Hereby, Panasonic Connect Co., Ltd. declares that this product is in compliance with the essential requirements and other relevant provisions of the Directive 2014/53/EU."

If you want to get a copy of the original DoC of this product, please visit the following website:

<http://www.ptc.panasonic.eu>

Authorized Representative:

Panasonic Connect Europe GmbH

Panasonic Testing Centre

Winsbergring 15, 22525 Hamburg, Germany

Indoor use restrictions are to be followed for the following countries if using 5 GHz frequency band.

AT	BE	BG	HR	CY	CZ	DK	EE	FI	FR	DE	EL
HU	IS	IE	IT	LV	LI	LT	LU	MT	NL	NO	PL
PT	RO	SK	SI	ES	SE	CH	TR	UK(NI)			

### Declaration of Conformity (DoC) for UK:

"Hereby, Panasonic Connect Co., Ltd. declares that this product is in compliance with the essential requirements and other relevant provisions of the Radio Equipment Regulations 2017."

If you want to get a copy of the original DoC of this product, please visit the following website:

<http://www.ptc.panasonic.eu>

Importer for UK:

Panasonic Connect UK, a branch of Panasonic Connect Europe GmbH, Maxis 2, Western Road, Bracknell, Berkshire, RG12 1RT

Indoor use restrictions are to be followed for the UK if using 5 GHz frequency band.

#### WLAN: Maximum Power

18 dBm (2.400 GHz - 2.483.5 GHz)

16 dBm (5.150 GHz - 5.250 GHz)

15.5 dBm (5.945 GHz - 6.425 GHz)

# Request Regarding Security

**When using this product, take safety measures against the following incidents.**

- Personal information being leaked via this product
- Unauthorized operation of this product by a malicious third party
- Interfering or stopping of this product by a malicious third party

**Take sufficient security measures.**

## **Precautions on security when using wireless LAN products**

- The advantage of a wireless LAN is that information can be exchanged between a PC or other such equipment and an access point using radio waves as long as you are within range for radio transmissions. On the other hand, because the radio waves can travel through obstacles (such as walls) and are available everywhere within a given range, problems of the type listed below may occur if security-related settings are not made.
  - A malicious third-party may intentionally intercept and monitor transmitted data including the content of e-mail and personal information such as your ID, password, and/or credit card numbers.

- A malicious third-party may access your personal or corporate network without authorization and engage in the following types of behaviour.
  - Retrieve personal and/or secret information (information leak)
  - Spread false information by impersonating a particular person (spoofing)
  - Overwrite intercepted communications and issue false data (tampering)
  - Spread harmful software such as a computer virus and crash your data and/or system (system crash)

- Since most wireless LAN adaptors or access points are equipped with security features to take care of these problems, you can reduce the possibility of these problems occurring when using this product by making the appropriate security settings for the wireless LAN device.
- Some wireless LAN devices may not be set for security immediately after purchase. To decrease the possibility of occurrence of security problems, before using any wireless LAN devices, be absolutely sure to make all security-related settings according to the instructions given in the operation manuals supplied with them.

Depending on the specifications of the wireless LAN, a malicious third-party may be able to break security settings by special means.

If you cannot perform security settings for your wireless LAN by yourself, please contact the Panasonic dealer.

- Panasonic Connect Co., Ltd. asks customers to thoroughly understand the risk of using this product without making security settings, and recommends that the customer make security settings at their own discretion and responsibility.

### Notes on handling the transmitter

When disconnecting the transmitter from a computer, hold the cable connector to remove it.

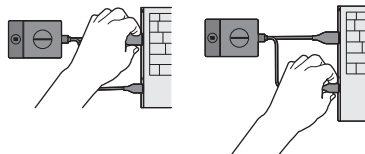

Pulling on the cable by holding the transmitter will put stress on the cable and result in a malfunction.

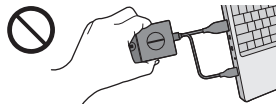



# Specifications

## ■ Receiver

Model No.	TY-WPR2
<b>Product name</b>	WPS Receiver
<b>Video output</b>	HDMI × 1 (HDCP2.2)
<b>Output resolution</b>	1920 x 1080/60p, 3840 x 2160/60p (max.)
<b>Number of simultaneous connections</b>	32
<b>Wireless communication standard</b>	IEEE802.11b/g/a/n/ac/ax Bluetooth (GFSK, π/4-DQPSK, 8DPSK)
<b>Data rate wireless</b>	2.4 Gbps (Maximum theoretical value)
<b>Frequency band</b>	2.4 GHz-bands 2,400 MHz to 2,483.5 MHz 1/2/3/4/5/6/7/8/9/10/11/12/13 channel 5 GHz-band 5,150 MHz to 5,250 MHz 36/40/44/48 channels 6 GHz-bands 5,945 MHz to 6,425 MHz 1/5/9/13/17/21/25/29/33/37/41/45/49/53/57/ 61/65/69/73/77/81/85/89/93 channels
<b>Security</b>	WPA/WPA2/WPA3 (WPA3-Enterprise is not supported)
<b>Reachable distance</b>	5 GHz : Up to 30 m, 6 GHz : Up to 20 m (Locations with good visibility and radio wave conditions)

Model No.	TY-WPR2
<b>FUNCTION LED</b>	* The following describes typical colors and conditions.
<b>White blinking</b>	Pairing in progress
<b>White illumination</b>	Pairing complete
<b>LAN terminal</b>	RJ45 × 1 10BASE-T/100BASE-TX supported
<b>USB terminal</b>	USB receptacle Type-A × 2
<b>Audio out terminal</b>	Stereo mini jack (φ 3.5 mm) × 1 0.25 V [rms]
<b>Power supply</b>	DC 5 V/2 A
<b>Dimensions (W × H × D)</b>	156 mm × 26 mm × 97.5 mm / 6.14" × 1.02" × 3.84" (excluding antennas)
<b>Mass</b>	Approx. 270 g / 0.6 lbs
<b>Operating condition</b>	Temperature: 0 °C to 35 °C (32 °F to 95 °F) Humidity: 20 % to 80 % (no condensation)
<b>Storage condition</b>	Temperature: -20 °C to 60 °C (-4 °F to 140 °F) Humidity: 20 % to 80 % (no condensation)

## ■ Transmitter

Model No.	TY-WPB2	TY-WPBC2
<b>Product name</b>	WPS Transmitter	WPS USB-C Transmitter
<b>Video input</b>	HDMI × 1 (HDCP1.4)	USB Type-C × 1 (HDCP1.4, DisplayPort Alt Mode)
<b>Input resolution</b>	1920 x 1080/60p, 3840 x 2160/30p (max.)	
<b>Wireless communication standard</b>	IEEE802.11ac/ax Bluetooth (GFSK, π /4-DQPSK, 8DPSK)	
<b>Data rate wireless</b>	1.2 Gbps (max.)	
<b>Frequency band</b>	5 GHz-bands 5,150 MHz to 5,250 MHz 36/40/44/48 channels 6 GHz-bands 5,945 MHz to 6,425 MHz 1/5/9/13/17/21/25/29/33/37/41/45/49/53/57/ 61/65/69/73/77/81/85/89/93 channels	
<b>Security</b>	WPA2/WPA3 (WPA3-Enterprise is not supported)	
<b>Reachable distance</b>	5 GHz : Up to 30 m, 6 GHz : Up to 20 m (Locations with good visibility and radio wave conditions)	
<b>Main LED</b>	* The following describes typical colors and conditions.	
<b>White blinking</b>	Standby (no signal input), pairing in progress	
<b>White illumination</b>	Standby or pairing complete	
<b>Red blinking</b>	Connecting	
<b>Red illumination</b>	Operation disabled	

Model No.	TY-WPB2	TY-WPBC2
<b>Green blinking</b>	Image being displayed (no signal input)	
<b>Green illumination</b>	Image being displayed	
<b>Blue blinking</b>	Fixed mode (no signal input)	
<b>Blue illumination</b>	Fixed mode	
<b>Sub LED</b>		
<b>Green illumination</b>	Multi-screen mode	
<b>Power supply</b>	DC 5 V/0.9 A	
<b>Dimensions (W × H × D)</b>	61.3 mm × 19.8 mm × 87.3 mm / 2.41" × 0.78" × 3.44" (excluding cables) 61.3 mm × 19.8 mm × 297.3 mm / 2.41" × 0.78" × 11.71" (including cables)	61.3 mm × 19.8 mm × 87.3 mm / 2.41" × 0.78" × 3.44" (excluding cables) 61.3 mm × 19.8 mm × 192.3 mm / 2.41" × 0.78" × 7.57" (including cables)
<b>Mass</b>	Approx. 130 g / 0.3 lbs	Approx. 100 g / 0.3 lbs
<b>Operating condition</b>	Temperature: 0 °C to 35 °C (32 °F to 95 °F) Humidity: 20 % to 80 % (no condensation)	
<b>Storage condition</b>	Temperature: -20 °C to 60 °C (-4 °F to 140 °F) Humidity: 20 % to 80 % (no condensation)	

## Software License

This product incorporates the following software:

- (1) the software developed independently by or for Panasonic Connect Co., Ltd.,
- (2) the software owned by third party and licensed to Panasonic Connect Co., Ltd.,
- (3) the software licensed under the GNU General Public License, Version 2.0 (GPL V2.0),
- (4) the software licensed under the GNU LIBRARY General Public License, Version 2.0 (LGPL V2.0),
- (5) the software licensed under the GNU LESSER General Public License, Version 2.1 (LGPL V2.1), and/or
- (6) open source software other than the software licensed under the GPL V2.0, LGPL V2.0 and/or LGPL V2.1.

The software categorized as (3) - (6) are distributed in the hope that it will be useful, but WITHOUT ANY WARRANTY, without even the implied warranty of MERCHANTABILITY or FITNESS FOR A PARTICULAR PURPOSE. For details, see the license conditions displayed by selecting [Software licenses], following the specified operation from the Web setting screen of this product.

At least three (3) years from delivery of this product, Panasonic Connect Co., Ltd. will give to any third party who contacts us at the contact information provided below, for a charge no more than our cost of physically performing source code distribution, a complete machine-readable copy of the corresponding source code covered under GPL V2.0, LGPL V2.0, LGPL V2.1 or the other licenses with the obligation to do so, as well as the respective copyright notice thereof.

Contact Information:

[oss-cd-request@gg.jp.panasonic.com](mailto:oss-cd-request@gg.jp.panasonic.com)

### Trademark Credits

- HDMI, High-Definition Multimedia Interface and the HDMI Logo are trademarks or registered trademarks of HDMI Licensing Administrator, Inc. in the United States and other countries.
- USB Type-C and USB-C are trademarks or registered trademarks of USB Implementers Forum.
- PressIT is a trademark of Panasonic Holdings Corporation.

Even if no special notation has been made of company or product trademarks, these trademarks have been fully respected.

## Disposal of Old Equipment

### Only for European Union and countries with recycling systems



This symbol on the products, packaging, and/or accompanying documents mean that used electrical and electronic products must not be mixed with general household waste.

For proper treatment, recovery and recycling of old products, please take them to applicable collection points in accordance with your national legislation.

By disposing of them correctly, you will help to save valuable resources and prevent any potential negative effects on human health and the environment.

For more information about collection and recycling, please contact your local authority.

Penalties may be applicable for incorrect disposal of this waste, in accordance with national legislation.

### Customer's Record

The model number and serial number of this product may be found on its rear panel. You should note this serial number in the space provided below and retain this book, plus your purchase receipt, as a permanent record of your purchase to aid in identification in the event of theft or loss, and for Warranty Service purposes.

**Model Number**

**Serial Number**

Manufactured by:  
Panasonic Connect Co., Ltd.  
4-1-62 Minoshima, Hakata-ku, Fukuoka 812-8531, Japan  
Importer:  
Panasonic Connect Europe GmbH  
Hagenauer Strasse 43, 65203 Wiesbaden, Germany

Authorized Representative in EU:  
Panasonic Connect Europe GmbH  
Panasonic Testing Centre  
Winsbergring 15, 22525 Hamburg, Germany

Importer for UK:  
Panasonic Connect UK,  
a branch of Panasonic Connect Europe GmbH,  
Maxis 2, Western Road, Bracknell, Berkshire, RG12 1RT

**Panasonic Connect Co., Ltd.**

4-1-62 Minoshima, Hakata-ku, Fukuoka 812-8531, Japan

Web Site: <https://panasonic.net/cns/prodisplays/>

© Panasonic Connect Co., Ltd. 2024

English

Printed in Taiwan