

## Operating Instructions

WALL MOUNT For business use

English

Model No.

**TY-WMM1**  
**TY-WML1**  
**TY-WMS1**

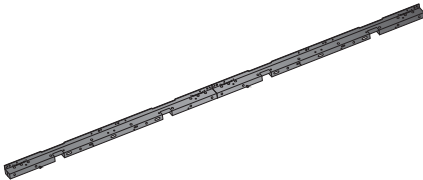

### Contents

|                                     |   |
|-------------------------------------|---|
| Important Safety Instructions ..... | 2 |
| Safety Precautions .....            | 2 |
| Precautions for use .....           | 4 |
| Accessories .....                   | 5 |
| Installation .....                  | 6 |
| Specifications .....                | 6 |

- Please read these instructions before operating your set and retain them for future reference.
- This Operating Instructions is applicable for TY-WMM1, TY-WML1, and TY-WMS1.
- The components are separate accessories included in the TL-110AD12AJ package.  
The components cannot be purchased or used alone.
- Illustrations and screens in this Operating Instructions are images for illustration purposes, and may be different from the actual ones.
- Unless otherwise indicated, illustrations in these operating instructions are of TY-WMM1.

# Important Safety Instructions

- 1) Read these instructions.
- 2) Keep these instructions.
- 3) Heed all warnings.
- 4) Follow all instructions.
- 5) Clean only with dry cloth.
- 6) Protect the power cord from being walked on or pinched particularly at plugs, convenience receptacles, and the point where they exit from the apparatus.
- 7) Only use attachments / accessories specified by the manufacturer.
- 8) Use only with the cart, stand, tripod, bracket, or table specified by the manufacturer, or sold with the apparatus. When a cart is used, use caution when moving the cart / apparatus combination to avoid injury from tip-over.
- 9) Refer all servicing to qualified service personnel. Servicing is required when the apparatus has been damaged in any way, such as power-supply cord or plug is damaged, liquid has been spilled or objects have fallen into the apparatus, the apparatus has been exposed to rain or moisture, does not operate normally, or has been dropped.



# Safety Precautions

## WARNING

### ■ Setup

- To prevent the unit from tumbling down or falling, check the installation location is strong enough for the weight of the unit and accessories before installation.

**We are not responsible for any product damage, etc. caused by failures in the installation environment even during the warranty period.**

Small parts can present choking hazard if accidentally swallowed. Keep small parts away from young children. Discard unneeded small parts and other objects, including packaging materials and plastic bags/sheets to prevent them from being played with by young children, creating the potential risk of suffocation.

**Do not place the unit on sloped or unstable surfaces, and ensure that the unit does not hang over the edge of the base.**

- The unit may fall off or tip over.

**Install this unit at a location with minimal vibration and which can support the weight of the unit.**

- Dropping or falling of the unit may cause injury or malfunction.

**When using this unit, be sure to take safety measures to prevent falling or dropping of the unit.**

- If an earthquake occurs or a child climbs the unit, the unit may fall or drop, resulting in an injury.

### Cautions for Wall Installation

- The installation should be performed by an installation professional. Installing the unit incorrectly may lead to an accident that results in death or serious injury.
- Before installation, be sure to check if the mounting location has enough strength to support the weight of the unit and the wall hanging bracket for anti drop.
- If you terminate the use of the product, ask a professional to remove it promptly.

**Ensure that the installation location is strong enough for this unit when it is used for a long term.**

- If the installation location is not strong enough for this unit when it is used for a long term, this unit may fall and cause injury.

**To avoid getting accidentally squeezed between the unit and the wall or a mounting fixture, the installer should make sure that there is nobody in the surrounding area before starting the unit installation or removal work.**

- Injury may be caused by having your fingers or hands accidentally squeezed between objects.

## ■ When using the unit

**If problems or malfunction occur, stop using immediately.**

**Do not attempt to disassemble or alter the unit in any way.**

- The unit may have damage or fall, and cause injury.

**All parts and accessories included in the product package should be stored out of children's reach.**

- These items are detrimental to human health if accidentally swallowed.
- Please contact a doctor immediately in case you doubt that the child may have swallowed it.

## CAUTION

**Do not place the unit upside down.**

**Do not install the unit, making its front face upward or downward.**

**Install the mounting screws and power cable in such a way that they will not make contact with the inside parts of the wall.**

- Electric shocks may result from contact with any metal objects inside the wall.

**Do not fit at any locations subject to humidity, dust, smoke, steam or heat.**

- This may have an adverse effect on the unit and cause fire or electric shock.

**Do not place the unit in a place where it can be exposed to the weather, salt damage, or corrosive gas.**

- Doing so may cause the unit to fall due to corrosion, and it may result in injury. Also, the unit may malfunction.

**The installer should avoid getting their hands or fingers pinched during installation.**

- Such pinching could lead to Injury.

**We do not assume responsibility for any accident or damage that is caused as a result of attempting to install or handle the unit in any way not specified in our operating instructions/installation instructions or by using any part or material other than the ones specified.**

**Do not step on, or hang from the unit.**

- They might tip over, or might be broken and it may result in injury. Pay special attention to the children.

**Unpack and carry the unit with assistance of other workers.**

- It may fall and cause injury.

**Do not use the components for any unit not specified in the catalog.**

- The unit may fall and cause injury.

**If the unit is deformed or cracked, do not use it.**

- It may tumble over and become damaged, resulting in injury.  
In case the unit is damaged, contact your dealer immediately.

**Install the unit on a level and stable surface.**

- It may fall, get damaged, and cause injury.

**When assembling, be sure to securely fasten all screw fastening points.**

- If assembled improperly, the unit may not have enough strength, tumble over, and become damaged, resulting in injury.
- The tightening torques are specified in the assembly instructions.

**Do not subject the unit to excessive force or impact.**

- Doing so may result in damage to the unit and/or personal injury.

# Precautions for use

## ■ Cautions when installing

**Follow the instructions below when installing the unit.**

**Even before expiration of the warranty period, we do not assume responsibility for any damage arising from installing the unit in an inappropriate environment.**

**This unit must be installed in an indoor location. Even inside a building, avoid installing the unit in the following types of locations:**

- Where the unit is exposed to the weather
- Where the unit may be subject to drastic changes in temperature or humidity, for example near an air conditioning device
- Where the unit may receive vibration or impact
- Near a fire sprinkler or sensor

**Do not install the unit where it may receive vibration or impact.**

- Vibration or impact on the unit may damage its internal parts and can lead to mechanical failure. Choose a place free from vibration or impact to install the unit.

**Install this unit at a location which can support the weight of the unit.**

- Dropping or falling of the unit may cause injury.

**Environmental temperature to use this unit**

- When using the unit where it is below 1 400 m (4 593 ft) above sea level: 0 °C to 40 °C (32 °F to 104 °F)
- When using the unit at high altitudes (1 400 m (4 593 ft) and higher and below 2 800 m (9 186 ft) above sea level): 0 °C to 35 °C (32 °F to 95 °F)

## ■ When using

**Do not apply an adhesive tape or sticker to the unit.**

- The unit surface will become soiled.

**Do not keep the unit in contact with a rubber or soft plastic material for an extensive period of time.**

- Unit deterioration may be caused.

## ■ Cleaning and maintenance

**To remove dirtiness on the unit (except for the LED Module surface), wipe gently with soft antistatic cloth (cotton fabric or flannel).**

### Note

- Static charges may cause electrical circuit failure.
- Wiping the unit surface with stiff cloth or rubbing the surface hard may cause mechanical failure.

# Accessories

## Product

The number shown in < > is the quantity of the item included in the package.

**Wall mount <1 of each>**

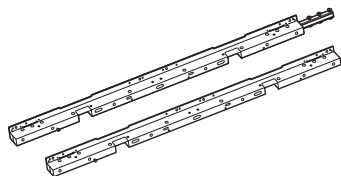

## Accessories Supply

Check that you have the accessories and items shown. The number shown in < > is the quantity of the item included in the package.

**M6-14 screw <6>**

**For connecting brackets**

DPVF4993ZA/X1



**M6-14 screw\* <2>**

**For positioning the stand**

DPVF4992ZA/X1



\* The screws are used only to attach the unit to the stand.

The screws are not used to attach the unit to a wall.

### Attention

- Store small parts in an appropriate manner, and keep them away from young children.
- The part numbers of accessories are subject to change without notice. (The actual part number may differ from those shown.)
- In case you lost accessories, please purchase them from your dealer. (Available from the customer service)
- Dispose the packaging materials appropriately after taking out the items.
- When tightening screws, use a torque driver or torque wrench; do not use an electric screwdriver or impact driver.

# Installation

**Note**

- When tightening screws, use a torque driver or torque wrench; do not use an electric screwdriver or impact driver.

## 1 Connecting the wall mount brackets.

Connect the two wall mount brackets and secure them with M6-14 screws (6 places).  
Connect the wall mount brackets so that they are flat.

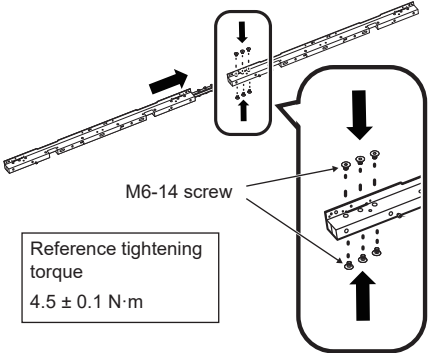

## 2 Check that the wall mount brackets are firmly connected.

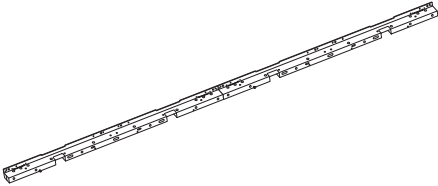

## 3 Install the connected bracket on a wall or on the stand.

Read the Installation Instructions for TL-110AD12AW.

For instructions on how to use the screws for positioning the stand, refer to the Installation Instructions for TL-110AD12AW.

To download the Installation Instructions, please visit the Panasonic website (<https://docs.connect.panasonic.com/prodisplays/>).



# Specifications

|                           |  |
|---------------------------|--|
| Dimensions<br>(W × H × D) | 2 324 mm × 51 mm × 57 mm /<br>91.50" × 2.01" × 2.25" |
| Mass                      | Approx. 4.6 kg / 10.2 lbs                            |



Customer’s Record

The model number and serial number of this product may be found on its rear panel. You should note this serial number in the space provided below and retain this book, plus your purchase receipt, as a permanent record of your purchase to aid in identification in the event of theft or loss, and for Warranty Service purposes.

| Model Number | Serial Number |
|--------------|---------------|
|--------------|---------------|

Manufactured by:  
Panasonic Projector & Display Corporation  
2-15 Matsuba-cho, Kadoma City, Osaka 571-8503, Japan  
Importer:  
Panasonic Connect Europe GmbH  
Hagenauer Strasse 43, 65203 Wiesbaden, Germany  
Authorized Representative in EU:  
Panasonic Connect Europe GmbH  
Panasonic Testing Centre  
Winsbergring 15, 22525 Hamburg, Germany

Importer for UK:  
Panasonic Connect UK,  
a branch of Panasonic Connect Europe GmbH,  
Maxis 2, Western Road, Bracknell, Berkshire, RG12 1RT

Panasonic Projector & Display Corporation

2-15 Matsuba-cho, Kadoma City, Osaka 571-8503, Japan  
Web Site: <https://docs.connect.panasonic.com/prodisplays/>