

Operating Instructions

POWER BOX For business use

English

Model No. **TY-PWRBX3W**



Contents

Important Safety Instructions	2
Important Safety Notice	3
Safety Precautions	4
Precautions for use	7
Accessories	9
Cautions when moving	10
Connections	11
Assembly, Installation, and Connection	16
Operation	17
Specifications	17

- Please read these instructions before operating your set and retain them for future reference.
- This device is a dedicated system component for the TL-165AD19AW unit which is separately sold from the unit. This device cannot be purchased or used separately from the above-named unit.
- Illustrations and screens in this Operating Instructions are images for illustration purposes, and may be different from the actual ones.



WARNING
RISK OF ELECTRIC SHOCK
DO NOT OPEN



WARNING: To reduce the risk of electric shock, do not remove cover.

No user-serviceable parts inside. Refer servicing to qualified service personnel.



The lightning flash with arrow-head within a triangle is intended to tell the user that parts inside the product are a risk of electric shock to persons.



The exclamation point within a triangle is intended to tell the user that important operating and servicing instructions are in the papers with the appliance.

WARNING:

To prevent damage which may result in fire or shock hazard, do not expose this apparatus to rain or moisture.

Do not place a container filled with water or other liquid on top of the unit.

WARNING:

- 1) To prevent electric shock, do not remove cover. No user serviceable parts inside. Refer servicing to qualified service personnel.
- 2) Do not remove the grounding pin on the power plug. This apparatus is equipped with a three pin grounding-type power plug. This plug will only fit a grounding-type power outlet. This is a safety feature. If you are unable to insert the plug into the outlet, contact an electrician.
Do not defeat the purpose of the grounding plug.

Important Safety Instructions

- 1) Read these instructions.
- 2) Keep these instructions.
- 3) Heed all warnings.
- 4) Follow all instructions.
- 5) Clean only with dry cloth.
- 6) Do not block any ventilation openings. Install in accordance with the manufacturer's instructions.
- 7) Do not install near any heat sources such as radiators, heat registers, stoves, or other apparatus (including amplifiers) that produce heat.
- 8) Do not defeat the safety purpose of the polarized or grounding-type plug. A polarized plug has two blades with one wider than the other. A grounding type plug has two blades and a third grounding prong. The wide blade or the third prong are provided for your safety. If the provided plug does not fit into your outlet, consult an electrician for replacement of the obsolete outlet.
- 9) Protect the power cord from being walked on or pinched particularly at plugs, convenience receptacles, and the point where they exit from the apparatus.
- 10) Only use attachments / accessories specified by the manufacturer.
- 11) Unplug this apparatus during lightning storms or when unused for long periods of time.
- 12) Refer all servicing to qualified service personnel. Servicing is required when the apparatus has been damaged in any way, such as power-supply cord or plug is damaged, liquid has been spilled or objects have fallen into the apparatus, the apparatus has been exposed to rain or moisture, does not operate normally, or has been dropped.
- 13) To prevent electric shock, ensure the grounding pin on the AC cord power plug is securely connected.

Important Safety Notice

WARNING

- 1) To prevent damage which may result in fire or shock hazard, do not expose this appliance to dripping or splashing.
Do not place a container filled with water or other liquid on top of the unit.
Do not place any objects on top of the device.
- 2) To prevent electric shock, do not remove cover. No user serviceable parts inside. Refer servicing to qualified service personnel.
- 3) Do not remove the earthing pin on the power plug. This apparatus is equipped with a three pin earthing-type power plug. This plug will only fit an earthing-type power outlet. This is a safety feature. If you are unable to insert the plug into the outlet, contact an electrician.
Do not defeat the purpose of the earthing plug.
- 4) To prevent electric shock, ensure the earthing pin on the AC cord power plug is securely connected.

CAUTION

This appliance is intended for use in environments which are relatively free of electromagnetic fields.

Using this appliance near sources of strong electromagnetic fields or where electrical noise may overlap with the input signals could cause the picture and sound to wobble or cause interference such as noise to appear.

Using this appliance near sources of strong electromagnetic fields or where electrical noise may overlap with the input signals could cause the sensor function not to work correctly.

To avoid the possibility of harm to this appliance, keep it away from sources of strong electromagnetic fields.

WARNING:

This equipment is compliant with Class A of CISPR32. In a residential environment this equipment may cause radio interference.

IMPORTANT INFORMATION: Stability Hazard

Never place the unit in an unstable location. The unit may fall, causing serious personal injury or death. Many injuries, particularly to children, can be avoided by taking simple precautions such as:

- Using cabinets or stands recommended by the manufacturer of the unit.
- Only using furniture that can safely support the unit.
- Ensuring the unit is not overhanging the edge of the supporting furniture.
- Not placing the unit on cloth or other materials that may be located between the unit and supporting furniture.
- Educating children about the dangers of climbing on furniture to reach the unit or its controls.

If the existing unit is going to be retained and relocated, the same considerations as above should be applied.

Safety Precautions

WARNING

■ Setup

Please have the installation performed by qualified service personnel.

Improper installation may result in death or serious injury.

- Attach to a wall using the special wall mounts included in the FHD LED Display (TL-165AD19AW) package.
- To prevent the wall-mounted unit from falling, check that the wall in the mounting area is sufficiently strong to support the weight of the unit and the Wall Mounts.
- The Power Box should be installed using the fittings included in the FHD LED Display (TL-165AD19AW) package.
- Install the control box (TY-CTRFHD3W) on an ANSI/EIA-310-D-compliant rack.
- When the product is no longer in use, promptly have it removed by qualified service personnel.

We are not responsible for any product damage, etc. caused by failures in the installation environment even during the warranty period.

Small parts can present choking hazard if accidentally swallowed. Keep small parts away from young children. Discard unneeded small parts and other objects, including packaging materials and plastic bags/sheets to prevent them from being played with by young children, creating the potential risk of suffocation.

Do not place the unit on sloped or unstable surfaces, and ensure that the unit does not hang over the edge of the base.

- The unit may fall off or tip over.

Install this unit at a location with minimal vibration and which can support the weight of the unit.

- Dropping or falling of the unit may cause injury or malfunction.

When using this unit, be sure to take safety measures to prevent falling or dropping of the unit.

- If an earthquake occurs or a child climbs the unit, the unit may fall or drop, resulting in an injury.

Cautions for Wall Installation

- The installation should be performed by an installation professional. Installing the unit incorrectly may lead to an accident that results in death or serious injury.
- Before installation, be sure to check if the mounting location has enough strength to support the weight of the unit and the wall hanging bracket for anti drop.
- If you terminate the use of the product, ask a professional to remove it promptly.

To avoid getting accidentally squeezed between the unit and the wall or a mounting fixture, the installer should make sure that there is nobody in the surrounding area before starting the unit installation or removal work.

- Injury may be caused by having your fingers or hands accidentally squeezed between objects.

■ When using the unit

The unit is designed to operate on 200 – 240 V AC, 50/60 Hz.

If problems or malfunction occur, stop using immediately.

If problems occur, unplug the power supply plug.

- Smoke or an abnormal odour come out from the unit.
- No picture appears or no sound is heard, occasionally.
- Liquid such as water or foreign objects got inside the unit.
- The unit has deformed or broken parts.

If you continue to use the unit in this condition, it could result in fire or electric shock.

- Unplug the power supply plug from the wall outlet, and then contact the dealer for repairs.
- To cut off the power supply to this unit completely, you need to unplug the power supply plug from the wall outlet.
- Repairing the unit yourself is dangerous, and shall never be done.
- To enable to unplug the power supply plug immediately, use the wall outlet which you can reach easily.

Do not touch the unit directly by hand when it is damaged.

- Electric shock could occur.

Do not stick any foreign objects into the unit.

- Do not insert any metal or flammable objects into the ventilation holes or drop them onto the unit, as doing so can cause fire or electric shock.

Do not attempt to disassemble or alter the unit in any way.

- High voltages which can cause fire or electric shocks are present inside the unit. For any inspection, adjustment and repair work, please contact your local Panasonic dealer.

Ensure that the mains plug is easily accessible.

The mains plug shall be connected to a mains socket outlet with a protective earthing connection.

Do not use any power supply cord other than that provided with this unit.

- Doing so may cause short-circuit, generates heat, etc., which could cause electric shock or fire.

Do not use the supplied power supply cord with any other devices.

- Doing so may cause short-circuit, generates heat, etc., which could cause electric shock or fire.

Clean the power supply plug regularly to prevent it becoming dusty.

- If there is a build up of dust on the plug, the resultant humidity may cause short-circuit, which could cause electric shock or fire. Unplug the power supply plug from the wall outlet and wipe it with a dry cloth.

Do not handle the power supply plug with wet hands.

- Doing so may cause electric shocks.

Use a 30 A outlet exclusively for this unit.

- Using a 30 A outlet together with other units may cause fire due to heat generation.

Make sure to connect the power supply connectors (on the unit) of the power supply cords (for outlet connection) of the Power Box (TY-PWRBX3W) to AC IN and make sure they are locked.

- Doing so may cause short-circuit, generates heat, etc., which could cause electric shock or fire.
- For each of the connectors, plug it fully to the end, turn it clockwise, and make sure it is locked.

Make sure that the mains plug is fully inserted into the socket outlet and the power supply connector is fully inserted into the Power Box, Control Box or Cabinet Module.

- Incomplete insertion may cause electric shock or fire due to heating.
- Do not keep using a damaged mains plug or a loose socket outlet.
- Make sure that the power supply connector is locked.
- For each of the power supply connectors (on the unit) of the power supply cords (for outlet connection) of the Power Box (TY-PWRBX3W), plug it fully to the end, turn it clockwise, and make sure it is locked.

Do not do anything that may damage the power supply cord or the power supply plug.

- Do not damage the cable, make any modifications to it, place heavy objects on top of it, heat it, place it near any hot objects, twist it, bend it excessively or pull it. To do so may cause fire and electric shock. If the power cable is damaged, have it repaired at your local Panasonic dealer.

Do not touch the power supply cord or the plug directly by hand when they are damaged.

- Doing so may cause electric shock or fire due to short-circuit.

All parts and accessories included in the product package should be stored out of children's reach.

- These items are detrimental to human health if accidentally swallowed.
- Please contact a doctor immediately in case you doubt that the child may have swallowed it.

CAUTION

Do not close or plug any of the air vents in the unit.

Do not place the unit in a narrow, poorly ventilated place.

Do not place the unit upside down.

Do not place the unit in contact with fabric material, for example under a table cloth or on a carpet or bedclothes.

- Heat buildup inside the unit may lead to fire or mechanical failure.

Install the mounting screws and power cable in such a way that they will not make contact with the inside parts of the wall.

- Electric shocks may result from contact with any metal objects inside the wall.

Do not pull or snag the connection cable.

- This may cause the unit to fall or tip over, resulting in injury.
- Pay special attention to children.

Do not fit at any locations subject to humidity, dust, smoke, steam or heat.

- This may have an adverse effect on the unit and cause fire or electric shock.

Do not place the unit in a place where it can be exposed to the weather, salt damage, or corrosive gas.

- Doing so may cause the unit to fall due to corrosion, and it may result in injury. Also, the unit may malfunction.

The installer should avoid getting their hands or fingers pinched during installation.

- Such pinching could lead to Injury.

We do not assume responsibility for any accident or damage that is caused as a result of attempting to install or handle the unit in any way not specified in our operating instructions/installation instructions or by using any part or material other than the ones specified.

When disconnecting the power supply cord, make sure to do so by holding the mains plug (when disconnecting from the socket outlet) or the power supply connector (when disconnecting from the unit).

- Pulling the cord may damage the cord, and it may cause electric shock or fire due to short-circuit.

If the unit needs to be moved, make sure to do so after disconnecting the power supply cord and all the device connection cables and also removing any anti-tip/anti-drop anchor installed.

- If the unit is moved while some of the cables are still connected, the cables may become damaged, and fire or electric shock could result.

Disconnect the power supply plug from the wall socket as a safety precaution before carrying out any cleaning.

- Electric shocks can result if this is not done.

Do not step on, or hang from the unit.

- They might tip over, or might be broken and it may result in injury. Pay special attention to the children.

Do not subject the unit to excessive force or impact.

- Doing so may result in damage to the unit and/or personal injury.

Precautions for use

■ Cautions when installing

Follow the instructions below when installing the unit.

Even before expiration of the warranty period, we do not assume responsibility for any damage arising from installing the unit in an inappropriate environment.

This unit must be installed in an indoor location. Even inside a building, avoid installing the unit in the following types of locations:

- Where the unit is exposed to the weather
- Where the unit may be subject to drastic changes in temperature or humidity, for example near an air conditioning device
- Where the unit may receive vibration or impact
- Near a fire sprinkler or sensor

Do not install the unit where it may receive vibration or impact.

- Vibration or impact on the unit may damage its internal parts and can lead to mechanical failure. Choose a place free from vibration or impact to install the unit.

Install this unit at a location which can support the weight of the unit.

- Dropping or falling of the unit may cause injury.

Do not install the unit near a high-voltage line or a power source.

- Installing the unit near a high-voltage line or a power source may receive interference.

Watch out for mutual interference between devices.

- Place the unit away from risks of video distortion or audio noises due to electromagnetic interference.

Environmental temperature to use this unit

- When using the unit where it is below 1 400 m (4 593 ft) above sea level: 0 °C to 40 °C (32 °F to 104 °F)
- When using the unit at high altitudes (1 400 m (4 593 ft) and higher and below 2 800 m (9 186 ft) above sea level): 0 °C to 35 °C (32 °F to 95 °F)

Make sure to allow sufficient air flow around and through the unit so as not to exceed these temperature ranges.

- Service life of the unit components may be shortened or mechanical failure may be caused.

Install the unit out of direct sunlight and also away from heat-generating devices.

- Even in an indoor location, direct sunlight can cause the LED module temperature to increase to result in mechanical failure.
- Cabinet deformation or failure can be caused.
- Excessive light or heat can cause mechanical failure or other problems arising from increase in the device temperature.
- Deterioration of video quality may be experienced.

Device connection should be made with the devices in de-energized condition.

- Connect the devices according to their respective manuals.

Securing a clearance distance around the installed unit

- If the unit is installed inside a protective casing or enclosure, make sure to offer adequate ventilation by providing a cooling fan or air vents so that the temperature around the unit (inside the casing or enclosure) including the front of the LED panel will be kept within the specified allowable operating temperature range.

In the case of storage, store the unit in a dry room.

■ Note for connection

Removing and inserting the power cord and connection cables

- When the unit has been installed on the wall, if the power cord and connection cables are difficult to remove and insert, make connections first before installation.
- Be careful not to allow the cables to be entangled. After installation is completed, insert the power plug to the outlet.

■ When using

Parts of the unit may become hot during use.

- Parts of the unit housing may become hot, but this is normal and does not affect unit performance or quality.

If the unit is not going to be used for any prolonged length of time, unplug the power supply plug from the wall outlet.

- If the unit is going to be stored without power connection, be sure to store it out of direct sunlight or moisture.

If the power is instantaneously interrupted or stopped, or if the power voltage is instantaneously lowered, the unit may not operate normally.

- In this case, turn off the power of the unit and the connected devices once, and then turn on the power again.

Do not apply an adhesive tape or sticker to the unit.

- The unit surface will become soiled.

Do not keep the unit in contact with a rubber or soft plastic material for an extensive period of time.

- Unit deterioration may be caused.

■ Connection via RJ45 terminals

The RJ45 terminal on the unit is a terminal dedicated for connecting only to the Control Box. Do not connect this terminal to a network device.

If the terminal is mistakenly connected to a network device, system failure may result.

Using the unit in a place where static charges easily build up should be avoided.

- You may experience frequent communication interruptions when the unit is being used in an area where static charges tend to build up, for example on a carpet. If this happens, eliminate the suspected cause of the static charge and other potential noise-generating factors, and then turn off the unit and all the devices connected to it and turn them on again.

Strong radio interference from a broadcast station or a radio communication device can prevent the unit from functioning correctly.

- If there is a system or device nearby that generates strong radio signals, position the unit as far away from such device as possible and/or cover the unit's LAN cable with a length of metal foil or metal conduit which is grounded at both ends.

■ Notes on AC IN and AC OUT

Connect AC IN to a socket outlet and AC OUT to the Cabinet Module and Control Box.

- A connection to an unspecified device may cause heat generation, resulting in malfunction or fire.

■ Cleaning and maintenance

Before cleaning the unit, make sure that the mains plug is disconnected from the socket outlet and double-check that the unit is not energized.

To remove dirtiness on the unit (except for the LED Module surface), wipe gently with soft antistatic cloth (cotton fabric or flannel).

Note

- Static charges may cause electrical circuit failure.
- Wiping the unit surface with stiff cloth or rubbing the surface hard may cause mechanical failure.

Use of chemically impregnated wipes

- Follow the instructions provided with the wipe when using the wipe on the unit.

Do not spray or apply volatile liquid on the unit such as insecticide, benzene or paint thinner.

- Exposure to volatile liquid may cause failure or mechanical damage of the unit and may also damage its surface coating.

Remove dust or dirt from unit airways such as the air vents.

- Dust may adhere to the vicinity of the ventilation holes depending on the usage environment. As a result, if the internal cooling of this unit or circulation of exhaust heat deteriorates, it may result in a decrease in brightness or a malfunction. Clean and remove dust from the ventilation holes.
- The amount of dust and dirt that adheres depends on the installation location and usage time.

■ Disposal

When disposing the product, ask your local authority or dealer about the correct methods of disposal.

Do not disassemble the product for disposal.

Accessories

Product

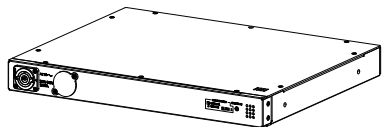

Accessories Supply

Check that you have the accessories and items shown. The number shown in < > is the quantity of the item included in the package.

Power supply cord

For connection to the socket outlet (approx. 3 m)

DPVF5130ZA/X1 (For EU/UK) <1>



Power supply cord

For connection to the Cabinet Module

DPVF5133ZA/X1
(approx. 4.5 m) (For EU/UK)
<1>

DPVF5131ZA/X1
(approx. 3.8 m) (For EU/UK)
<1>

DPVF5003ZA/X1
(approx. 2.4 m) (For EU/UK)
<3>

DPVF5004ZA/X1
(approx. 3.0 m) (For EU/UK)
<1>

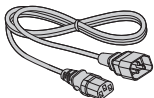

Sensor module <1>

Double-sided tape <2>

DPVF3677ZA/X1

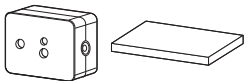

4-pole ultra mini cable <1>

DPVF3657ZA/X1

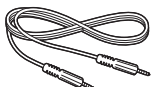

RJ-45 cable <1>

For power control

DPVF5132ZA/X1

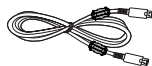

M6-8 bolt <4>

For retaining the box

DPVF5008ZA/X1



Cable tie wrap <20>

DPVF4980ZA/X1



Velcro strip <10>

DPVF4981ZA/X1



Attention

- Store small parts in an appropriate manner, and keep them away from young children.
- The part numbers of accessories are subject to change without notice. (The actual part number may differ from the ones shown above.)
- In case you lost accessories, please purchase them from your dealer. (Available from the customer service)
- Dispose the packaging materials appropriately after taking out the items.

Cautions when moving

Securely hold both ends of the unit to move it.

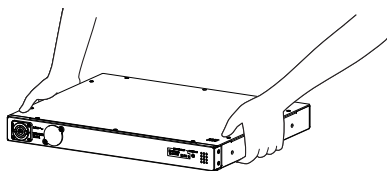

Note

- Mount the unit on a wall or stand with assistance of other workers.
- Be careful to keep the vertical and horizontal sides of the unit frame and also the unit corners away from other objects.
Collision with other objects may lead to mechanical failure.



- | | |
|--|---|
| 1 AC IN (Neutrik (NAC3MP-HC)): | AC power input terminal
Supplies AC power to AC OUT [A] and AC OUT [B]. |
| 2 SERVICE ONLY (for service use): | Service switch
Use at "1: NORMAL" except in a case of maintenance. |
| 3 SENSOR IN: | Sensor terminal
Connected to the included sensor module. (see page 14 "Installing the Sensor Module") |

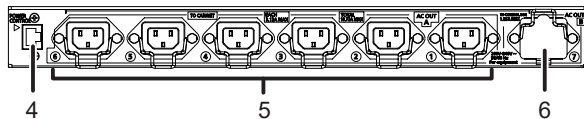

- | | |
|---|---|
| 4 POWER CONTROL: | Power Box control terminal
Connected to the control box (TY-CTRFHD3W), which is used to control the unit. |
| 5 AC OUT [A] (for Cabinet Module): | AC power output (for the Cabinet Module)
Used to supply AC power to the Cabinet Module (TY-FD19AS6/TY-FD19AS1B).
<div style="border: 1px solid black; border-radius: 10px; padding: 5px; margin: 10px 0;"> Note </div> <ul style="list-style-type: none"> ● Do not detach the cap supplied with ⑥. |
| 6 AC OUT [B] (for Control Box): | AC power output (for the Control Box)
Used to supply AC power when the control box (TY-CTRFHD3W) is installed nearby and it is uncapped. |

Before connecting

- Before connection, please read through the TL-165AD19AW Installation Instructions carefully. To download the Installation Instructions, please visit the Panasonic website (<https://docs.connect.panasonic.com/prodisplays/>).



- Turn off the power of all devices before connecting cables.
- Take note of the following points before connecting the cables. Failure to do so may result in malfunctions.
 - When connecting a cable to the unit or a device connected to the unit itself, touch any nearby metallic objects to eliminate static electricity from your body before performing work.
 - For the LAN cable between the unit and the component to be connected with it:
 - When this unit is to be installed behind TY-FD19AS6, use the LAN cable supplied with this unit.
 - When using a LAN cable other than the supplied LAN cable, we recommend using a LAN cable that is 30 m or less and compliant with CAT5e or better.
 - Do not use unnecessarily long cables to connect a device to the unit or to the unit body. The longer the cable, the more susceptible to noise it becomes. Since using a cable while it is wound makes it act like an antenna, it is more susceptible to noise.
 - When connecting cables, insert them straight into the connecting terminal of the connecting device so that the ground is connected first.
- When connecting the LAN cable with plug cover, be aware that the cover may come in contact with the back cover and it may be difficult to disconnect.

Connecting and Fastening the Power Supply Cord (on the socket outlet side)

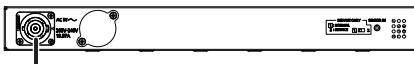

Connecting the power supply cord

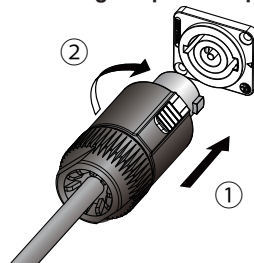

Plug the connector fully into an outlet (①) and turn it until you hear a click (②).

Note

- After you hear a click, try to turn the connector left and right again to make sure it does not turn.

Disconnecting the power supply cord

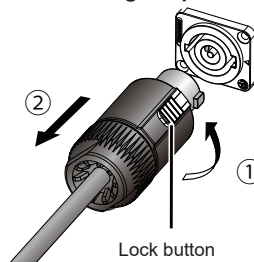

Turn the connector counterclockwise (①), pulling the lock button on the plug towards you, then pull it out (②).

Connecting and Fastening the Power Supply Cord (on the Cabinet Module side/Control Box side)

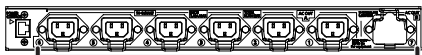

Connecting the power supply cord

1. Remove the cover (7) in the direction of the arrow shown in the figure.

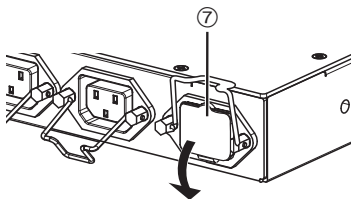

2. Plug the connector fully into the slot straight.

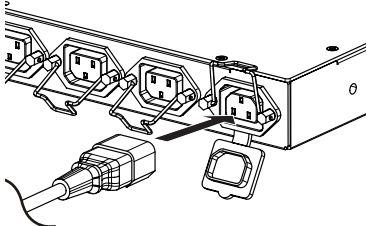

3. Push the power supply cord holder in the direction of the arrow shown in the figure so that the end of the power supply cord holder clicks into the power cord connector to fasten the power cord connector.

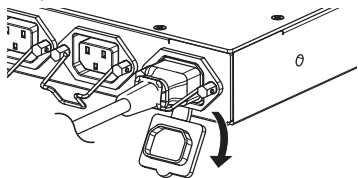

Disconnecting the power supply cord

1. Open the power supply cord holder fastening the power supply cord in the direction of the arrow shown in the figure.

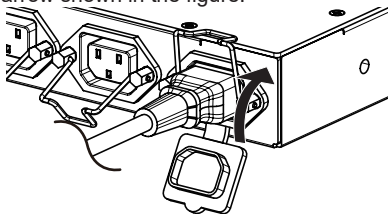

2. Hold the connector and pull it straight out.

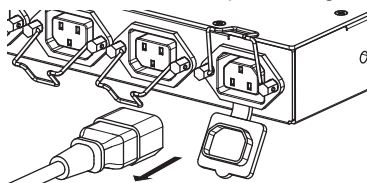

Connecting and Fastening the RJ-45 Cable

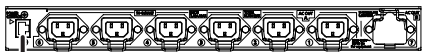

Connecting the RJ-45 cable

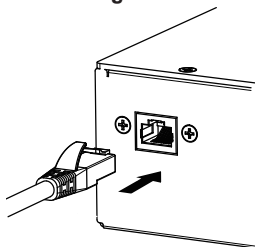

Plug the connector fully into the slot until it clicks.

Disconnecting the RJ-45 cable

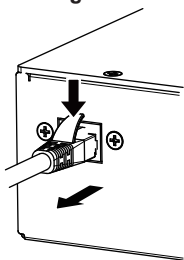

Unplug the connector, releasing the latch.

Note

- Do not use power supply cords or RJ-45 cables with a damaged latch. Continued use of a damaged latch may lead to electrical contact error at the connection terminal. Ask your dealer for repair of damaged cords.
- If a connector a power supply cord is plugged in is not secure or easily comes out, its contact may be loose. When you continue to use it as it is, the contact resistance at the terminal may increase, causing heat generation and fire. Be sure to consult your dealer.
- When disconnecting the power supply cord, be absolutely sure to disconnect the power supply cord plug at the socket outlet first.
- The supplied power supply cord is for this unit exclusive use. Do not use this for other purposes.

Installing the Sensor Module

By installing the included sensor module, you can use the environmental sensor function.

Note

- When installing or removing the sensor module, be sure to turn off the power of the display unit.

1 Connect the 4-pole ultra mini cable (accessory) to the sensor module

Note

- Make sure to plug the terminal of the 4-pole ultra mini cable fully to the end.

Sensor module

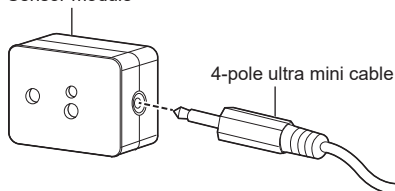

2 Peel off the release paper on one side of the double-sided tape and attach it to the top or bottom of the sensor module.

Note

- Wipe off any dust, water, oil, or other dirt from the surface to be pasted on, and press it firmly onto the surface to attach it.
- Double-sided tape cannot be reattached once it is pasted, so be sure to check the position it is pasted on carefully before pasting it.
- Fixing the sensor module with double-sided tape does not guarantee permanent retention. If it comes off due to external force or environmental condition, install it again with commercially available double-sided tape.

Release paper

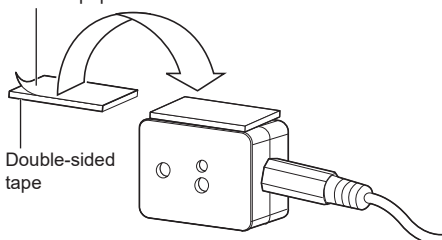

3 Peel off the remaining release paper on the other side of the double-sided tape and install the sensor module near the display.

Example of a location where the sensor is installed:

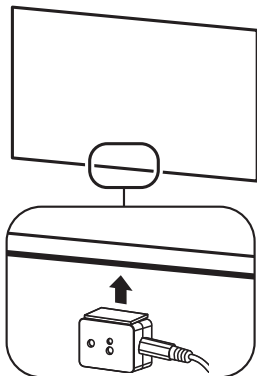

Note

- Install it in a location where the front of the sensor can detect environmental information.
- Wipe off any dust, water, oil, or other dirt from the surface to be pasted on, and press it firmly onto the surface to attach it.
- Double-sided tape cannot be reattached once it is pasted, so be sure to check the position it is pasted on carefully before pasting it.

4 Connect the other end of the 4-pole ultra mini cable to the SENSOR IN terminal.

Note

- Make sure to plug the terminal of the 4-pole ultra mini cable fully to the end.

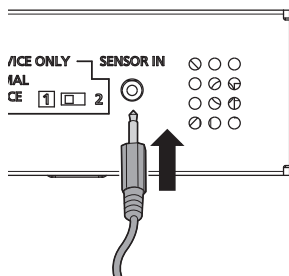

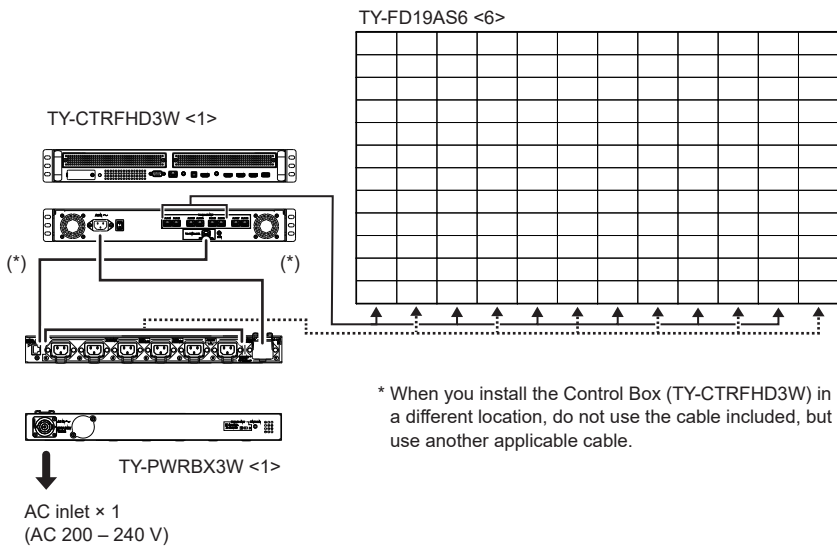

- Do not use a conversion plug. Connect the power plug directly to the wall outlet. Using a conversion plug may result in a poor contact of the power plug, which could cause heat generation and possibly result in a fire.
- This unit supports AC 200 V to AC 240 V as the power supply. A grounded outlet supporting 30 A is required. The shape of the usable outlet differs depending on the power supply.



2P/3W 32 A 250 V
Clock position 6h

Operation

Please read the Operating Instructions for TL-165AD19AW.

Specifications

Model No.	TY-PWRBX3W
Device type	Power Box
Power supply	AC IN AC 200 V – 240 V, 50 Hz / 60 Hz 19.97 A
Power consumption	4 W*1
Operating condition	Temperature: 0 °C – 40 °C (32 °F – 104 °F) *2 Humidity: 10 % – 80 % (no condensation)
Operating hours	24 hours/day
AC input terminal AC IN	Neutrik (NAC3MP-HC) × 1
AC output terminal AC OUT (for Cabinet)	IEC C13 × 6 AC OUT [A] AC OUT [A] AC 200 V – 240 V, 50 Hz / 60 Hz, 3.12 A (single) 18.72 A (total)
AC output terminal AC OUT (for Control Box)	IEC C13 × 1 AC OUT [B] AC OUT [B] AC 200 V – 240 V, 50 Hz / 60 Hz, 1.05 A
POWER CONTROL terminal POWER CONTROL	RJ45 × 1: For TY-PWRBX3W control
Sensor terminal SENSOR IN	4-pole ultra mini jack (Φ2.5 mm) × 1
Dimensions (W × H × D)	400 mm × 338 mm × 42 mm / 15.75" × 13.31" × 1.66"
Mass	Approx. 2.5 kg / 5.6 lbs

*1 Shipping condition
*2 Environmental temperature to use this unit at high altitudes (1 400 m (4 593 ft) and higher and below 2 800 m (9 186 ft) above sea level): 0 °C to 35 °C (32 °F to 95 °F)

Note

- Design and specifications are subject to change without notice. Mass and dimensions shown are approximate.

Disposal of Old Equipment

Only for European Union and countries with recycling systems



This symbol on the products, packaging, and/or accompanying documents means that used electrical and electronic products must not be mixed with general household waste.

For proper treatment, recovery and recycling of old products, please take them to applicable collection points in accordance with your national legislation.

By disposing of them correctly, you will help to save valuable resources and prevent any potential negative effects on human health and the environment.

For more information about collection and recycling, please contact your local authority.

Penalties may be applicable for incorrect disposal of this waste, in accordance with national legislation.



Customer’s Record

The model number and serial number of this product may be found on its rear panel. You should note this serial number in the space provided below and retain this book, plus your purchase receipt, as a permanent record of your purchase to aid in identification in the event of theft or loss, and for Warranty Service purposes.

Model Number	Serial Number

Manufactured by:
Panasonic Projector & Display Corporation
2-15 Matsuba-cho, Kadoma City, Osaka 571-8503, Japan
Importer:
Panasonic Connect Europe GmbH
Hagenauer Strasse 43, 65203 Wiesbaden, Germany
Authorized Representative in EU:
Panasonic Connect Europe GmbH
Panasonic Testing Centre
Winsbergring 15, 22525 Hamburg, Germany

Importer for UK:
Panasonic Connect UK,
a branch of Panasonic Connect Europe GmbH,
Maxis 2, Western Road, Bracknell, Berkshire, RG12 1RT

Panasonic Projector & Display Corporation

2-15 Matsuba-cho, Kadoma City, Osaka 571-8503, Japan
Web Site: <https://docs.connect.panasonic.com/prodisplays/>

© Panasonic Projector & Display Corporation 2025

English

Printed in China